

带发兰系列

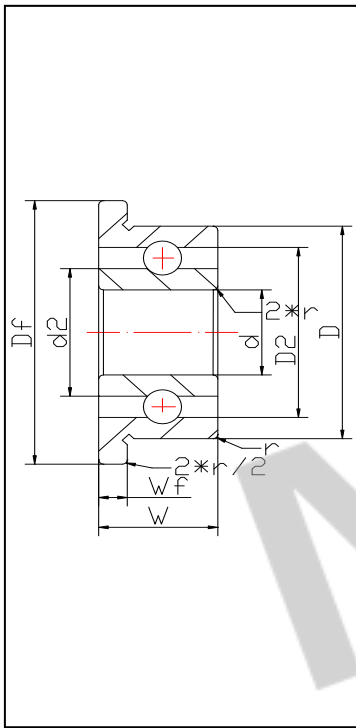

型号	d	D	Df	D2	De	Re	W	Wf	d2	d1	R1	B	游隙CO	Dw	Z	r	
MF52	2	5	6.2	4	4.3	0.88	2.5	0.6	3	2.7	0.84	2.5	/	0.8	7	0.2	*
FR133	2.381	4.762	5.944	4.07	4.37	0.88	2.38	0.787	3.07	2.771	0.84	2.381	/	0.8	7	0.2	*
FR144	3.175	6.35	7.518	5.26	5.56	0.88	2.779	0.787	4.2	3.96	0.84	2.779	/	0.8	7	0.2	*
FR2	3.175	9.525	11.176	7.5	7.938	1.667	3.967	0.762	5.2	4.762	1.636	3.967	/	1.588	6	0.3	*
FR2-5	3.175	7.938	9.12	6.05	6.35	0.88	3.571	0.79	5.05	4.75	0.82	3.571	/	0.8	7	0.2	*
FR84	4	8	9.2	6.5	6.8	0.88	3	0.6	5.5	5.2	0.84	3	/	0.8	7	0.2	*
FR684	4	9	10.3	7.1	7.5	1.06	4	1	5.9	5.5	1.03	4	/	1	7	0.2	*
FR156	4.762	7.938	9.12	6.85	7.15	0.88	3.175	0.91	5.85	5.55	0.84	3.175	60-90	0.8	7	0.3	*
FR166		9.525	10.71	7.45	7.75	0.88	3.175	0.79	6.45	6.15	0.84	3.175	60-90	0.8	8	0.3	*
FR166-T		9.525	10.71	7.45	7.75	0.88	3.175	0.79	6.45	6.15	0.84	3.96	/	0.8	8	0.3	*
FR166-A		9.525	10.71	7.45	7.75	0.88	3.68	0.58	6.45	6.15	0.84	3.68	60-90	0.8	8	0.3	*
FR3	5	12.7	14.351	10.1	10.7	2.1	4.978	1.067	7.35	6.7	2.06	4.978	50-80	2	8	0.4	*
FR85		8	9.2	7	7.3	0.88	3	0.6	6	5.7	0.84	3	/	0.8	7	0.2	*
FR85-2.5		8	9.2	7	7.3	0.88	2.5	0.6	6	5.7	0.84	2.5	/	0.8	7	0.2	*
FR95		9	10.2	7.5	7.8	0.88	3	0.6	6.5	6.2	0.84	3	/	0.8	7	0.2	*
FR105		10	11.6	7.5	7.8	0.88	4	0.8	6.5	6.2	0.84	4	/	0.8	7	0.2	*
FR685		11	12.5	9.2	9.626	1.667	5	1	6.75	6.45	1.636	5	50-80	1.588	9	0.3	*
FR605		14	16	10.9	11.5	2.1	5	1	8.1	7.5	2.06	5	50-80	2	8	0.4	

第41页

带发兰系列

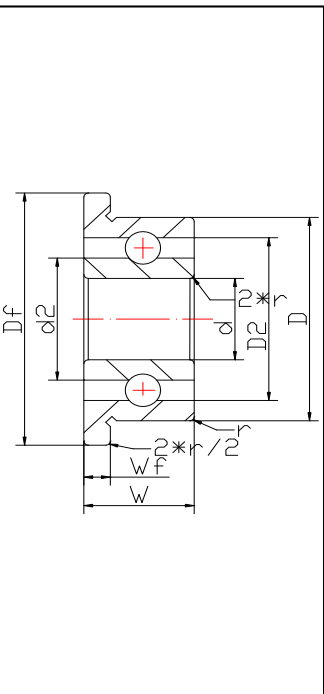

型号	d	D	Df	D2	De	Re	W	Wf	d2	d1	R1	B	游隙CO	Dw	Z	r	
FR106	6	10	11.2	8.5	8.8	0.88	3	0.6	7.5	7.2	0.84	3	/	0.8	7	0.2	*
FR126		12	13.6	9.6	10	1.06	4	0.8	8.4	8	1.03	4	50-80	1	8	0.2	*
FR686		13	15	11	11.5	2.1	5	1.1	7.9	7.5	2.06	5	50-80	2	8	0.4	*
FR4	6.35	15.875	17.526	13	13.49	2.5	4.98	1.067	9.2	8.731	2.4	4.98	60-90	2.381	8	0.5	*
FR168		9.525	10.71	8.44	8.738	0.88	3.175	0.91	7.44	7.14	0.84	3.175	60-90	0.8	7	0.3	*
FR188		12.7	13.89	10.713	11.113	1.667	4.762	1.143	8.338	7.938	1.636	4.762	60-90	1.588	9	0.4	*
FR607	7	19	22	15.5	16.175	3.32	6	1.5	10.45	9.825	3.26	6	60-90	3.175	6	0.5	
FR128	8	12	13.6	10.5	10.8	0.88	3.5	0.8	9.5	9.2	0.84	3.5	/	0.8	8	0.2	*
FR148		14	15.6	12.2	12.588	1.667	4	0.8	9.7	9.412	1.636	4	50-80	1.588	10	0.4	*
FR688-5		16	18	14.1	14.4	2.1	5	1.1	10.8	10.4	2.06	5	50-80	2	11	0.4	*
FR688-6		16	18	14.1	14.4	2.1	6	1.1	10.8	10.4	2.06	6	50-80	2	11	0.4	*
FR6	9.525	22.225	24.6	19.144	19.844	4.2	7.144	1.58	12.606	11.906	4.1	7.144	70-100	3.969	7	0.5	
FR6701	12	18	19.5	16.338	16.588	1.667	4	0.8	13.663	13.413	1.636	4	60-90	1.588	14	0.3	*
FR8	12.7	28.575	31.12	23.8	25.224	5	7.9	1.58	17.3	15.7	4.92	7.9	80-110	4.762	7	0.6	
FR1038	9.525	15.875	17.526	13.988	14.288	1.667	3.969	1.016	11.412	11.112	1.636	3.969	60-90	1.588	13	0.3	
FR6001	12	28	30	23.6	25.274	5	8	2	17.4	15.75	4.92	8	70-100	4.762	8	0.6	
FR6705	25	32	34	29.838	30.088	1.667	4	1	27.162	26.912	1.636	4	60-90	1.588	24	0.3	

第42页