

双列深沟系列

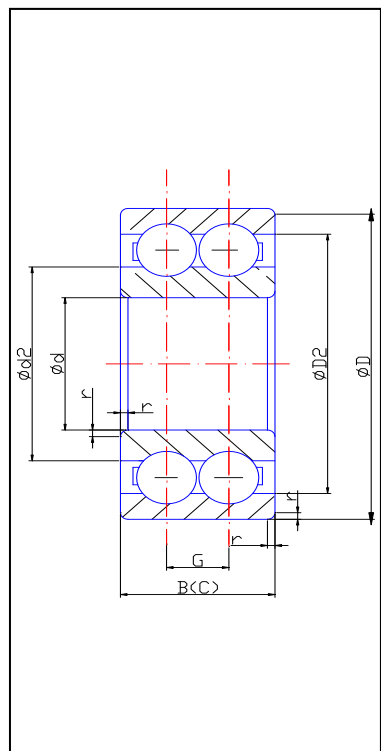

型号	d	D	D2	De	Re	C	d2	d1	R1	B	沟心距G	Dw	游隙	Z	r	
30/6	6	17	11.86	12.46	2.5	9	8.3	7.7	2.4	9	2.5/2.6	2.381	5-21	7*2	0.3	
308B	8	22	17.47	18.175	3.32	11	12.53	11.8	3.26	11	3.5/3.3	3.175	5-21	8*2	0.5	
非3200	10	30	23.9	25.18	5	14	17.25	15.64	4.9	14	5.1/4.9	4.762	6-23	8*2	1	
3200	10	30	23.9	25.18	5	14.3	17.25	15.64	4.9	14.3	5.1/4.9	4.762	6-23	8*2	1	
5200	同3200															
3001	12	28	23.07	23.969	4.2	12	16.93	16.03	4.1	12	4.3/4.15	3.969	6-23	9*2	0.6	
3201	12	32	25.6	27.6	5.8	15.9	18.44	16.4	5.72	15.9	5.8/5.65	5.556	6-23	7*2	1	
4201	12	32	25.2	26.762	5	14	18.8	17.238	4.9	14	5.1/4.9	4.762	6-23	8*2	1	
5201	12	32	25.6	27.6	5.8	16	18.44	16.4	5.72	16	5.8/5.65	5.556	6-23	7*2	1	
3202	15	35	28.6	30.556	5.8	15.9	21.4	19.44	5.72	15.9	5.86/5.56	5.556	6-23	8*2	1	
Y10	15.875	34.925	27.9	28.575	3.32	11.1125	22.9	22.225	3.26	11.1125	3.5/3.3	3.175	6-23	7*2	1	
5203	17	40	33.2	35.382	6.64	17.5	24.8	22.617	6.52	17.5	6.94/6.68	6.35	6-23	7*2	1	
CB-701	19.05	30.16	27.24	27.78	3.32	12.7	21.97	21.43	3.26	14.27	4.2/4	3.175	6-23	24*2	0.38*	45°
3204	20	47	39.2	42.348	8.34	20.6	29.3	26.45	8.16	20.6	8.2	7.938	7-25	8*2	1	
3004	20	42	34.262	35.762	5	15.875	27.738	26.238	4.9	15.875	5.1	4.762	7-25	9*2	1	
3006	30	55	47.1	49.247	7.08	19	37.9	35.753	6.94	19	7.3/7.1	6.747	8-27	10*2	1.2	
DAC19	19.05	44.45	37	40.481	9.16	23	26.5	23.019	9	23	9.1/9.42	8.731	5-20	7*2	1	
5208T3R500	40	85	68.3	72.7	13.34	31	51.7	47.3	13.08	38	14.11/13.48	12.7	13-38	9*2	1.5	
5208T3dw40	40	98	68.3	72.7	13.34	36	51.7	47.3	13.08	38	14.11/13.48	12.7	13-38	9*2	1.5	

双列深沟系列

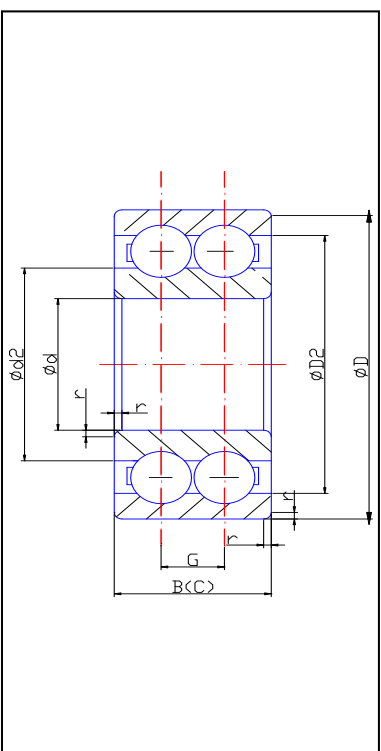

型号	d	D	D2	De	Re	C	d2	d1	R1	B	沟心距G	Dw	游隙	Z	r	
4205	25	52	42.9	45.257	7.08	18	33.8	31.753	6.94	18	7.1	6.747	85-140	10*2	1.2	
3205	25	52	43.7	39.394	7.5	20.6	34.5	32.34	7.35	20.6	7.65/7.4	7.144	8-27	10*2	1.2	
E14012																
-01	25.4	50.8	42.3	44.45	6.64	15.875	33.9	31.75	6.52	15.875	8.9/8.7	6.35	8-27	17*2	0.8	
3206	30	62	52.2	55.72	9.16	23.8	41.5	38.25	9	23.8	9.42/9.1	8.731	8-27	9*2	1.2	
3306-B	30	72	58.2	63.418	12.54	30	44.9	39.584	12.4	30	12.711/12.173	11.906	8-27	8*2	1.5	
4206	30	62	50.644	53.144	7.5	20	41.346	38.846	7.35	20	7.5	7.144	85-140	11*2	1.2	
3207	35	72	60.7	63.06	10	27	47.8	44	9.8	27	10.07/9.72	9.525	8-27	10*2	1.2	
3810	50	65	59.92	60.675	3.32	12	55.08	54.325	3.26	12	3.5/3.3	3.175	11-33	25*2	0.8	*
5210	50	90	78.4	82.8	13.34	30.2	61.8	57.4	13.08	30.2	13.1/12.9	12.7	11-33	10*2	1.2	
5208	40	80	68	72.225	11.66	30.2	54.3	49.975	11.44	30.2	12.85/12.3	11.1125	9-29	9*2	1.5	
5211	55	100	86	90.8	13.34	33.3	70.3	65.4	13.08	33.3	14.11/13.48	12.7	13-38	10*2	2	
5213	65	120	101.7	107.581	15.84	38.1	83.4	77.365	15.54	38.1	16.4/15.8	15.081	16-43	10*2	2	